

CLASS LINE UP FOR START AND END OF DAY 2022-2023

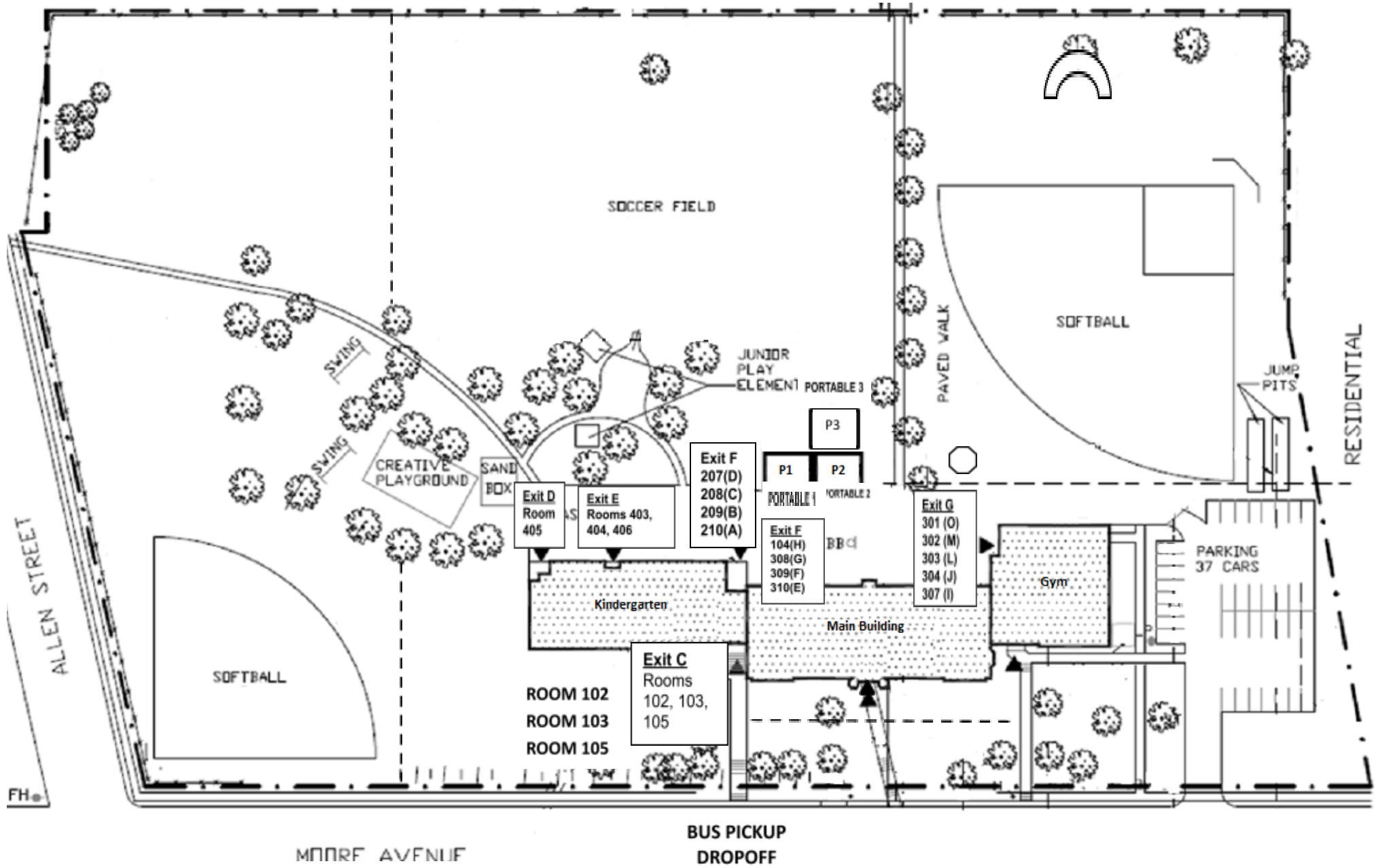

Class Line up Locations

Before/After School (Gym door)

I- 307, J-304, L-303 M-302 O-301

Before/After School (Red Tile Door)

210- A, 209- B 208-C 207-D

310-E 309-F 308-G 104-H

Before/After School (Portables)

P1: outside against P1

P2: Outside against P2

P3: Outside along patio stone walkway

Note:

Primary classrooms will come in the right door. Room 104 and classrooms on the third floor will come in the left door from the red-tiled area.